

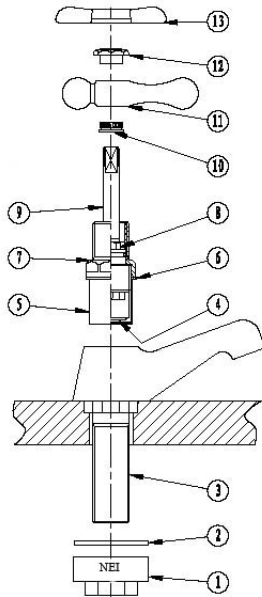

CERAMIC DISC PILLAR TAP

Congratulations for purchasing this quality Ewing Tapware Range. Our product is manufactured to the highest quality under strict quality control procedures.



1. Backing Nut
2. Fiber Washer
3. Body
4. Cartridge Seal
5. Ceramic Disc
6. Fiber Washer
7. Locking Nut
8. Spindle Nut
9. Spindle
10. Adaptor Ring
11. Lever Handle
12. Button
13. Button Spanner

Generic diagram dose not show the Pillar Tap Flange

Models.

Dallas
San Antonio
Pasadena
Santa Fe

Installation Instructions.

All pipe work must be thoroughly flushed prior to installation, as foreign materials may block the flow-regulating device and reduce the flow of water.

Please follow these instructions:

1. Remove the Pillar Tap backing nut (1) from the body (3). Place the Pillar Tap into the basin.
2. Replace the backing nut (1) along with the Fiber Washer (2) on the Pillar Tap and tighten, ensure that the Pillar Tap is secure.
3. Remove the locking nut (7) and the Fiber Washers (6) from the complete Spindle assembly (9). Screw the complete Spindle assembly (9) into the Pillar Tap Body; by hand until the cartridge is seated. Now tighten the complete Spindle assembly (9) until firm using a spanner on Spindle Nut (8) Place the Fiber washer (6) onto the Spindle (9) and screw the Locking Nut (7) back down and tighten with a spanner.
4. Fit the Flange (Not Shown) onto the Spindle (9). Tighten the flange by hand.
5. Fit the Adaptor Ring (10) to the spindle; Place the Handle (11) in the required position. Fit the Indicator Button (12) to Spindle; tighten the button firmly against the Handle (11) using the Button Spanner (13)
6. Connect the appropriate pipe work to the Pillar Tap body (1/2" BSP) and on to the corresponding water supply. This pipe work maybe Flexible Tails or Copper Pipe with nut and olive
7. Before turning the water supply back on, make sure the Pillar Tap is turned on slightly, this will allow any foreign matter to be removed.

For after Sales and Service in Australia
Phone: 1800 135 906
Fax: 07 3205 6905

PLEASE RETAIN YOUR PROOF OF PURCHASE

Warranty.

Thank you for choosing a quality Ewing Product that is manufactured to Australian Standards Requirements. Ewing Tapware (where applicable) has been rated under the Water Efficiency Labelling Scheme (WELS), our WELS licence number is 0037.

Technical Information

- ◆ Hot and Cold water inlet pressures should be equal.
- ◆ Inlet pressure must not exceed 500kPa.
- ◆ Minimum operating pressure of 150kPa is required.
- ◆ Maximum hot water temperature 80 degrees Celsius.
- ◆ Not suitable for gravity feed systems

Terms and Conditions.

Ewing Industries undertakes to repair, or at its option replace only, any product, which is defective through faulty workmanship or materials within 12 months of the purchase of the goods. The warranty period commences from the date of purchase. Ewing Industries reserves the right to provide components as 'parts only' to the customer. This warranty is only applicable for products purchased from an authorised Ewing Industries reseller. The labour component of the warranty does not cover excessive time taken to access or remove the product from its installed location. The warranty is limited to Ewing Industries products only and does not cover other manufactures products, which may be attached to Ewing Industries products.

Warranty may be void due to the following reasons :-

- ◆ Inability to provide proof of purchase.
- ◆ Products are not installed by a licensed plumber or in accordance with relevant industry standards or regulations.
- ◆ The product is exposed to water pressures that are greater than 500kPa and temperatures exceed 80 degrees Celsius.
- ◆ Products used for incorrect applications and in inappropriate locations.
- ◆ Products are cleaned with anything other than a soft cloth soaked with warm water. The use of abrasive cleaners or harsh detergents may void the warranty

Care and Cleaning.

Clean regularly with warm water and a soft cloth
Do not use abrasive cleaners or harsh detergents.